



COMPONENTS AND REPAIR MANUAL

2006 Perimeter Rd. Greenville, SC 29605
Toll Free: 800-435-9340 - Phone: 864-277-5870
Fax: 864-235-9661 - www.mightymole.com
email: mmole@mightymole.com

**MODEL
STEERING HEAD**

MACHINE SERIAL NO.:

MANUAL PART NO.: E851100

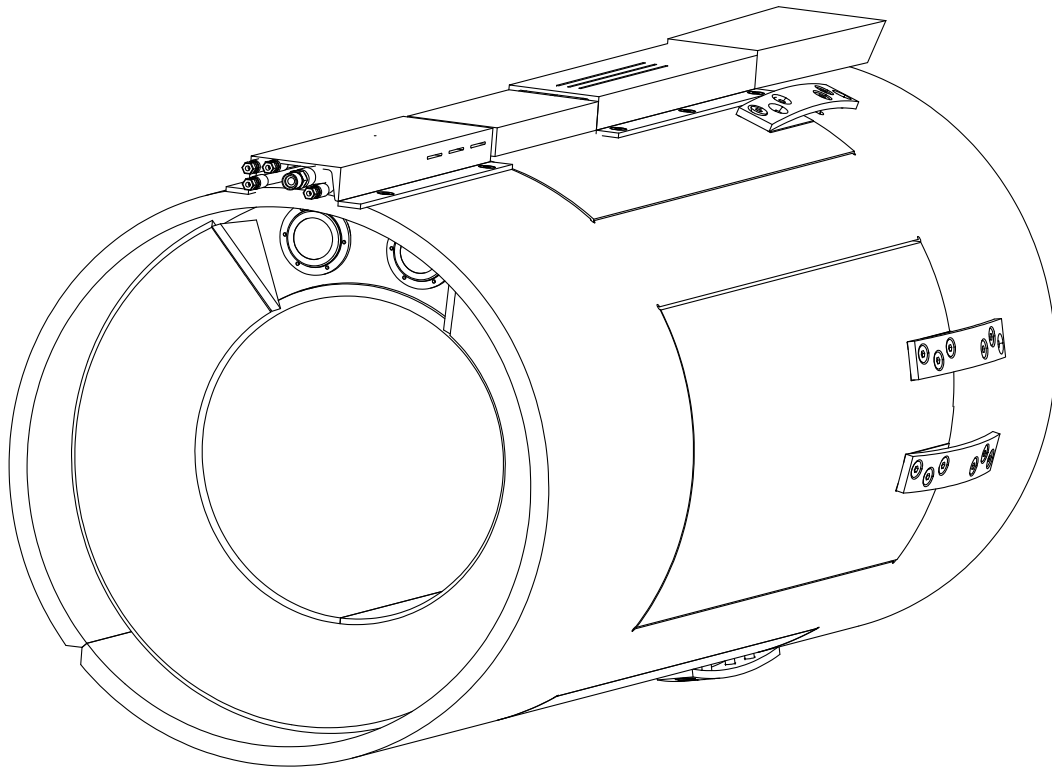

Machine Serial # _____

Purchased &
Serviced Thru: _____

Purchase Date: _____

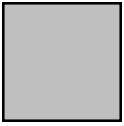

WARNING: Battery posts, terminals and related accessories contain lead and lead compounds, chemicals known to the State of California to cause cancer and birth defects or other reproductive harm. **Wash hands after handling.**

TABLE OF CONTENTS

OTS

<u>DESCRIPTION</u>	<u>PAGE</u>
Decal Placement	1.1.0
Machine Assemblies, Parts Details	
Steering Head	2.1.0
Flaps	2.2.0
Hydraulics	2.3.0
Electrical	2.4.0
Wiring Schematics	3.1.0

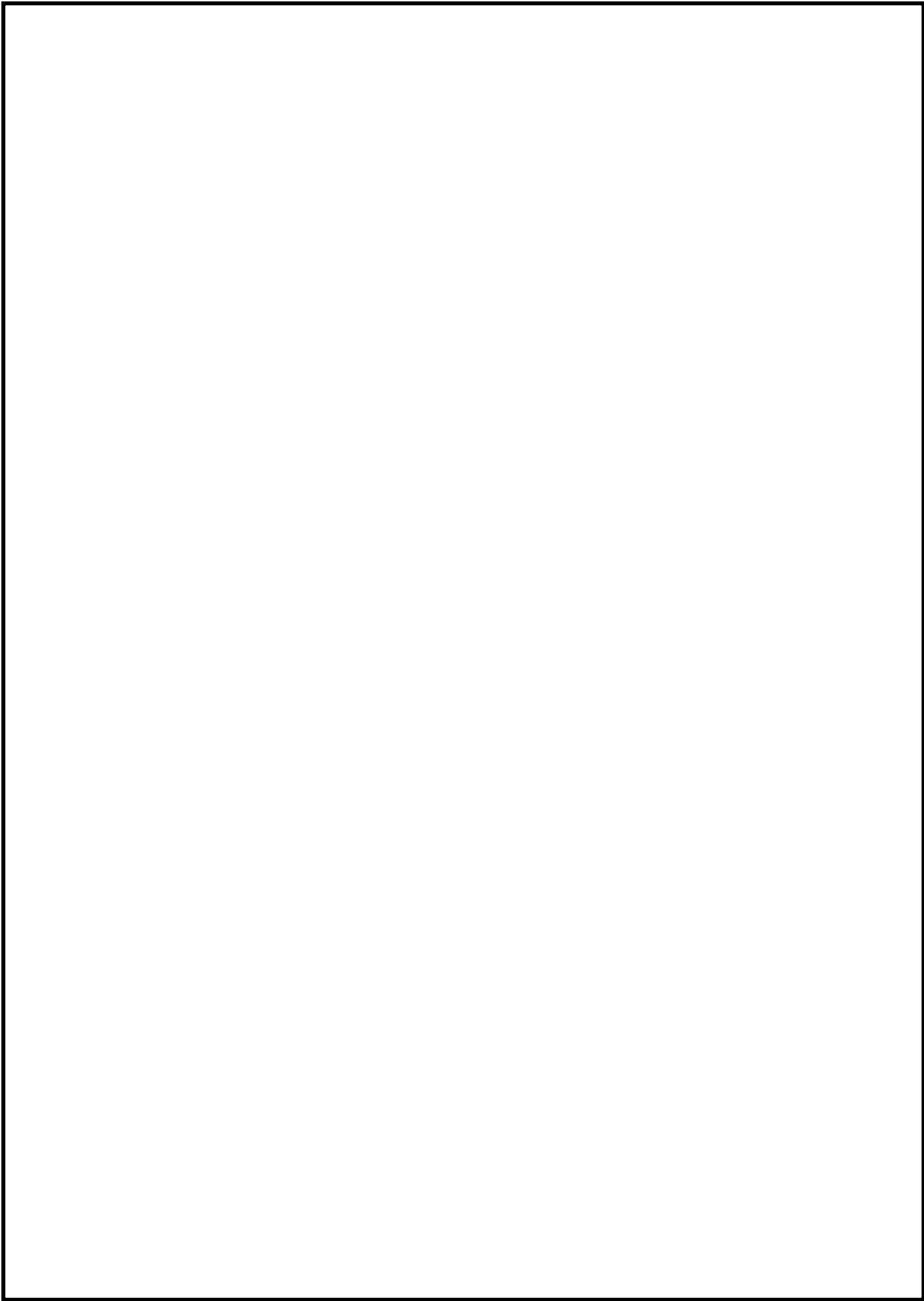

DECAL PLACEMENT

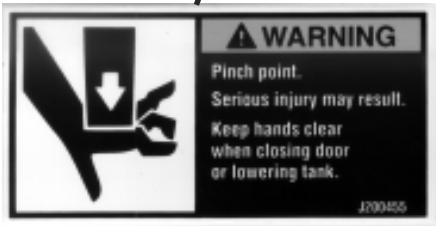

**J200455 - WARNING
PINCH POINT**



**J000100 - DANGER
ENTANGLEMENT HAZARD**

Steering Head

OTS

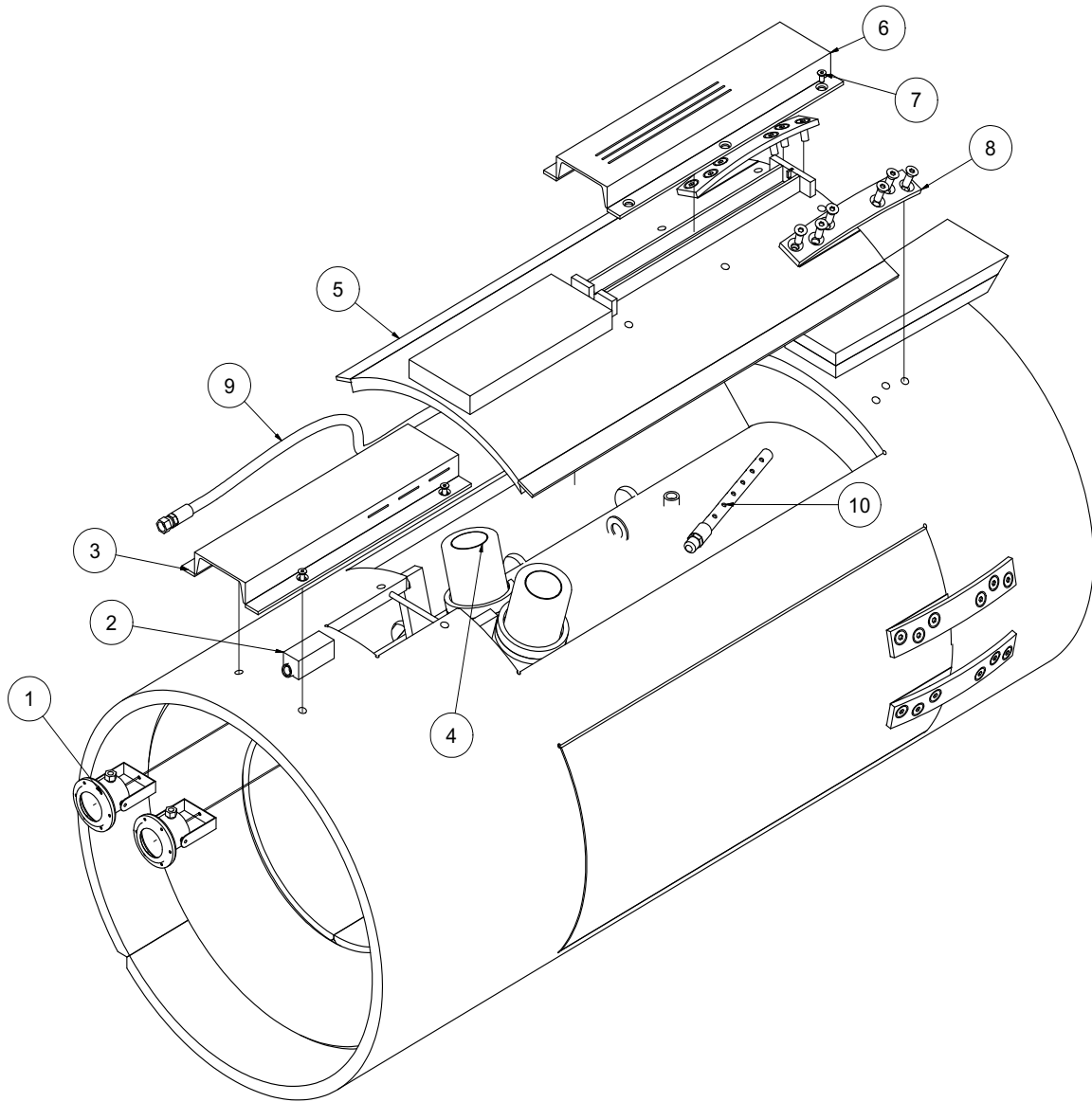

Steering Head

OTS

ITEM	QTY	PART NO.	DESCRIPTION
1	2	C501385	LIGHT, STEERING HEAD (30" - 60"OTS)
	2	C501386	BULB, LIGHT HOUSING, LED
	2	C500900	LIGHT, STEERING HEAD (20" - 24")
	2	C500900-01	BULB, LIGHT HOUSING, LED
2	1	C501176	WATER LEVEL BLOCK
3	1	C501192	INSPECTION COVER WELDMENT
4	8	C501019	CYLINDER, HYD. 10T STR HEAD (16", 20", 24"OTS)
	8	C501001	CYLINDER, HYD. 30T STR HEAD (30", 36" OTS)
	12		CYLINDER, HYD. 30T STR HEAD (42", 48" OTS)
	16		CYLINDER, HYD. 30T STR HEAD (54", 60" OTS)
5	1	C501181	TOP FLAP WELDMENT (30")
	1	C501201	TOP FLAP WELDMENT (16")
	1	C501202	TOP FLAP WELDMENT (20")
	1	C501203	TOP FLAP WELDMENT (24")
	1	C501204	TOP FLAP WELDMENT (36")
	1	C501205	TOP FLAP WELDMENT (42")
	1	C501206	TOP FLAP WELDMENT (48")
	1	C501207	TOP FLAP WELDMENT (54")
	1	C501208	TOP FLAP WELDMENT (60")
6	1	C501189	SONE HOUSING COVER WELDMENT
7	10	U030050	SCREW, HSH .500 - 13 X .75"
8	8	C500130	HINGE, FLAP (16", 20",24",30",36" OTS)
	48	C501106	SCREW, HSH .500-13 X 1.50"
	10	C500130	HINGE, FLAP (42", 48" OTS)
	60	C501106	SCREW, HSH .500-13 X 1.50"
	16	C500130	HINGE, FLAP (54",60" OTS)
	96	C501106	SCREW, HSH .500-13 X 1.50"
9	1	TH00160	HOSE, FLAP CHARGE #8-56" ST-ST
10	1	C501237	FLUSH TUBE ASSEMBLY

Steering Head (Flaps)

OTS

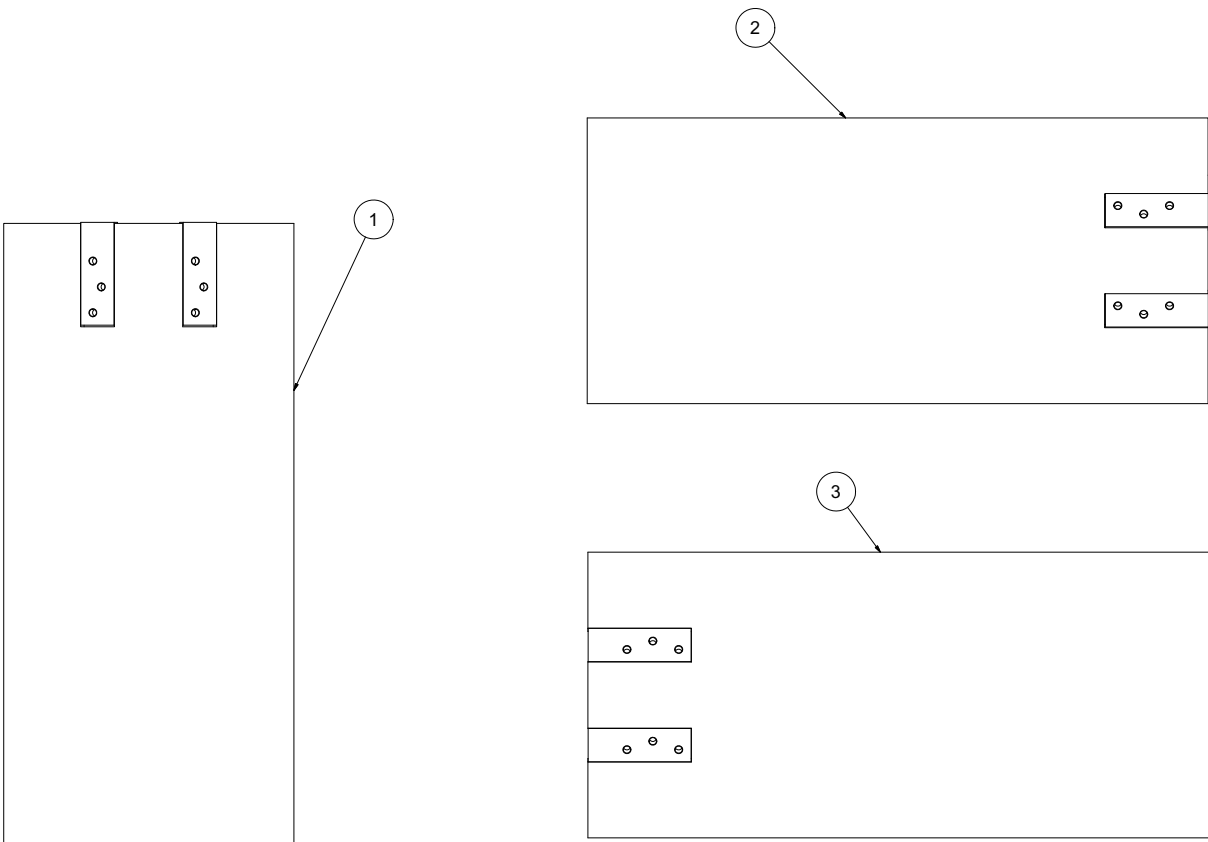

Steering Head (Flaps)

OTS

ITEM	QTY	PART NO.	DESCRIPTION	
1	1	C501162	BOTTOM FLAP WELDMENT (30"OTS)	
	1	C501209	BOTTOM FLAP WELDMENT (16"OTS)	
	1	C501210	BOTTOM FLAP WELDMENT (20"OTS)	
	1	C501211	BOTTOM FLAP WELDMENT (24"OTS)	
	1	C501212	BOTTOM FLAP WELDMENT (36"OTS)	
	1	C501213	BOTTOM FLAP WELDMENT (42"OTS)	
	1	C501214	BOTTOM FLAP WELDMENT (48"OTS)	
	1	C501215	BOTTOM FLAP WELDMENT (54"OTS)	
	1	C501216	BOTTOM FLAP WELDMENT (60"OTS)	
	2	1	C501163	RIGHT FLAP WELDMENT (30"OTS)
		1	C501225	RIGHT FLAP WELDMENT (16"OTS)
1		C501226	RIGHT FLAP WELDMENT (20"OTS)	
1		C501227	RIGHT FLAP WELDMENT (24"OTS)	
1		C501228	RIGHT FLAP WELDMENT (36"OTS)	
1		C501229	RIGHT FLAP WELDMENT (42"OTS)	
1		C501230	RIGHT FLAP WELDMENT (48"OTS)	
1		C501231	RIGHT FLAP WELDMENT (54"OTS)	
3	1	C501232	RIGHT FLAP WELDMENT (60"OTS)	
	1	C501164	LEFT FLAP WELDMENT (30"OTS)	
	1	C501217	LEFT FLAP WELDMENT (16"OTS)	
	1	C501218	LEFT FLAP WELDMENT (20"OTS)	
	1	C501219	LEFT FLAP WELDMENT (24"OTS)	
	1	C501220	LEFT FLAP WELDMENT (36"OTS)	
	1	C501221	LEFT FLAP WELDMENT (42"OTS)	
	1	C501222	LEFT FLAP WELDMENT (48"OTS)	
1	C501223	LEFT FLAP WELDMENT (54"OTS)		
1	C501224	LEFT FLAP WELDMENT (60"OTS)		

Steering Head (Hyd.)

OTS

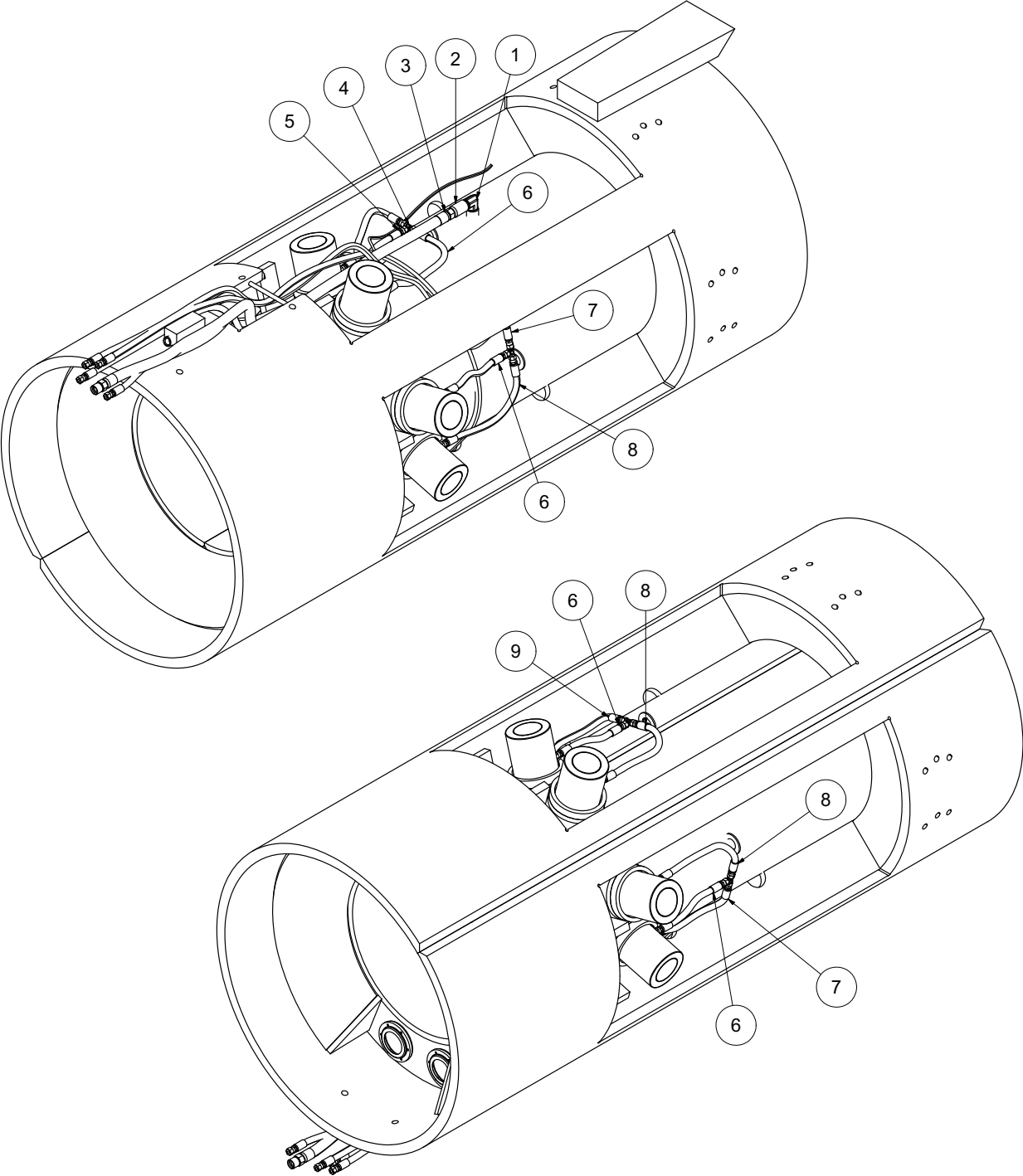

Steering Head (Hyd.)

OTS

ITEM	QTY	PART NO.	DESCRIPTION
1	1	T400490	ELBOW, 90 1/2"MP - 1/2"MP
2	1	T430030	COUPLING, 1/2" FNPT
3	1	TH00106	AUGER LUBRICATING LINE, 8-56" STMP-STMP
	2	T320350	FITTING, HOSE 1/2"MP - 1/2" HOSE
4	4	T402035	TEE, 1/4"MJ - 1/4"MJ - 1/4"MJ
5	1	8046814	TOP HYD. HOSE , 4-43" ST-ST
6	5	TH00107	CYLINDER HYD. HOSE 4-15" ST-ST
7	2	TH00108	SIDES HYD. HOSE 4-56" ST-ST
8	3	TH00109	CYLINDER HYD HOSE 4-21" ST-ST
9	1	TH00110	BOTTOM HYD. HOSE 4-78" ST-ST

Steering Head (Cutting Head)

OTS

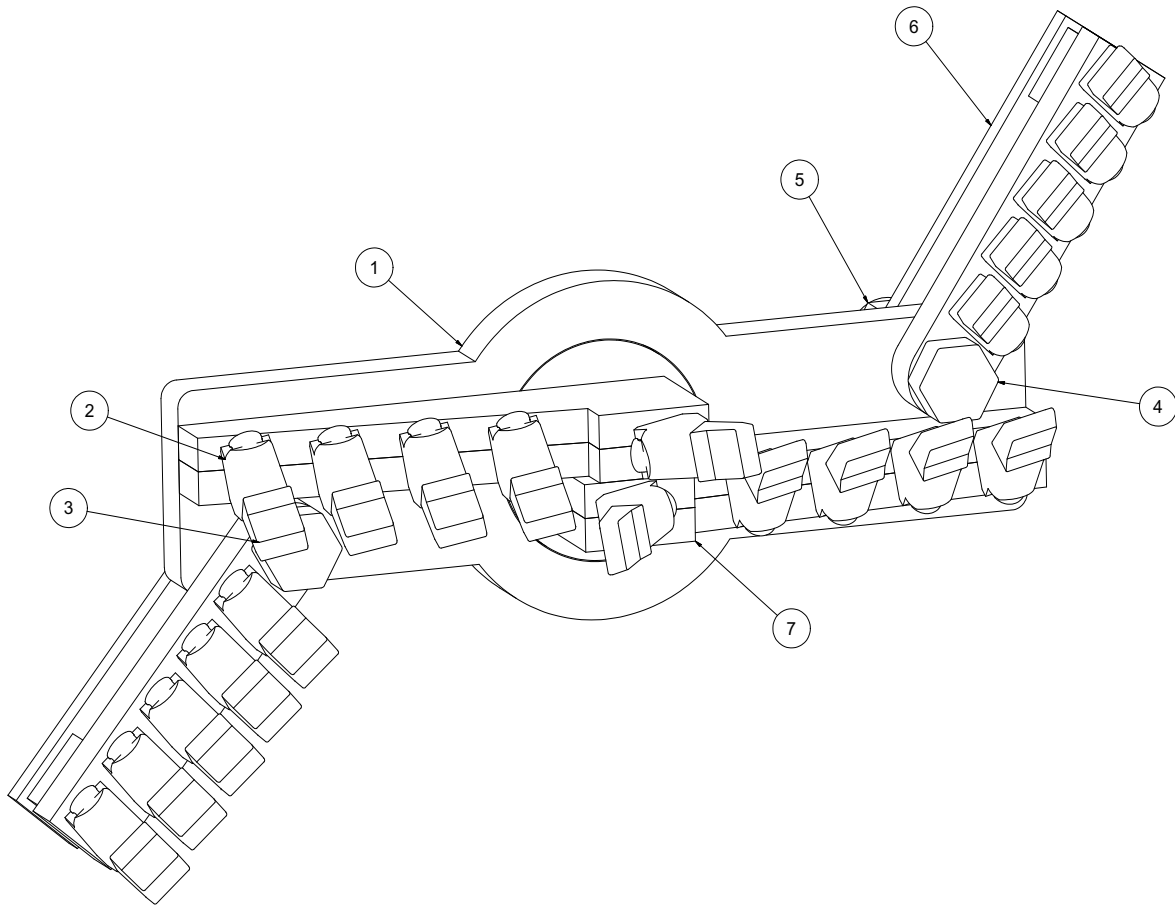

Steering Head (Cutting Head)

OTS

ITEM	QTY	PART NO.	DESCRIPTION
1	1	C501701	CUTTING HEAD BODY ASSY 16" OTS
		C501847	CUTTING HEAD BODY ASSY 20" OTS
		C501676	CUTTING HEAD BODY ASSY 24" OTS
		C501671	CUTTING HEAD BODY ASSY 30" OTS
		C501681	CUTTING HEAD BODY ASSY 36" OTS
		C501926	CUTTING HEAD BODY ASSY 42" OTS
		C501667	CUTTING HEAD BODY ASSY 48" OTS
		C501878	CUTTING HEAD BODY ASSY 60" OTS
2		S600800	BIT BLOCK, NON ROTATING
3		S600801	BIT, CARBIDE, NON ROTATING
	6		BITS FORCUTTING HEAD, 16" OTS
	6		BITS FORCUTTING HEAD, 20" OTS
	8		BITS FORCUTTING HEAD, 24" OTS
	8		BITS FORCUTTING HEAD, 30" OTS
	11		BITS FORCUTTING HEAD, 36" OTS
	13		BITS FORCUTTING HEAD, 42" OTS
	17		BITS FORCUTTING HEAD, 48" OTS
	21		BITS FORCUTTING HEAD, 60" OTS
4	2	U001571	SCREW, HC 1"-8 X 5.0 GR 8 - 16", 20", 24"
	2	U001599	SCREW, HC 1.50-6 X 6.0 GR 8 - 30" - 36"
	2	U001597	SCREW, HC 1.50-6 X 7.5 GR 8 - 42", 48", 60"
5	2	U120060	NUT, HEX, NYLOCK, 1"-8 - 16", 20", 24"
5	2	U100261	NUT, HEX, NYLOCK, 1.50-6 - 30" - 60"
6	2	C501735	WING CUTTER ASSEMBLY, 16"
	2	C501898	WING CUTTER ASSEMBLY, 20"
	2	C501299	WING CUTTER ASSEMBLY, 24"
	2	C501660	WING CUTTER ASSEMBLY, 30"
	2	C501296	WING CUTTER ASSEMBLY, 36"
	2	C501969	WING CUTTER ASSEMBLY, 42"
	2	C501910	WING CUTTER ASSEMBLY, 48"
	2	C501910	WING CUTTER ASSEMBLY, 60"
2		S600800	BIT BLOCK, NON ROTATING
3		S600801	BIT, CARBIDE, NON ROTATING
	1		BITS FOR EACH WING CUTTER, 16"
	3		BITS FOR EACH WING CUTTER, 20"
	3		BITS FOR EACH WING CUTTER, 24"
	4		BITS FOR EACH WING CUTTER, 30"
	5		BITS FOR EACH WING CUTTER, 36"
	5		BITS FOR EACH WING CUTTER, 42"
	5		BITS FOR EACH WING CUTTER, 48"
	5		BITS FOR EACH WING CUTTER, 60"

Steering Head (Electrical)

OTS

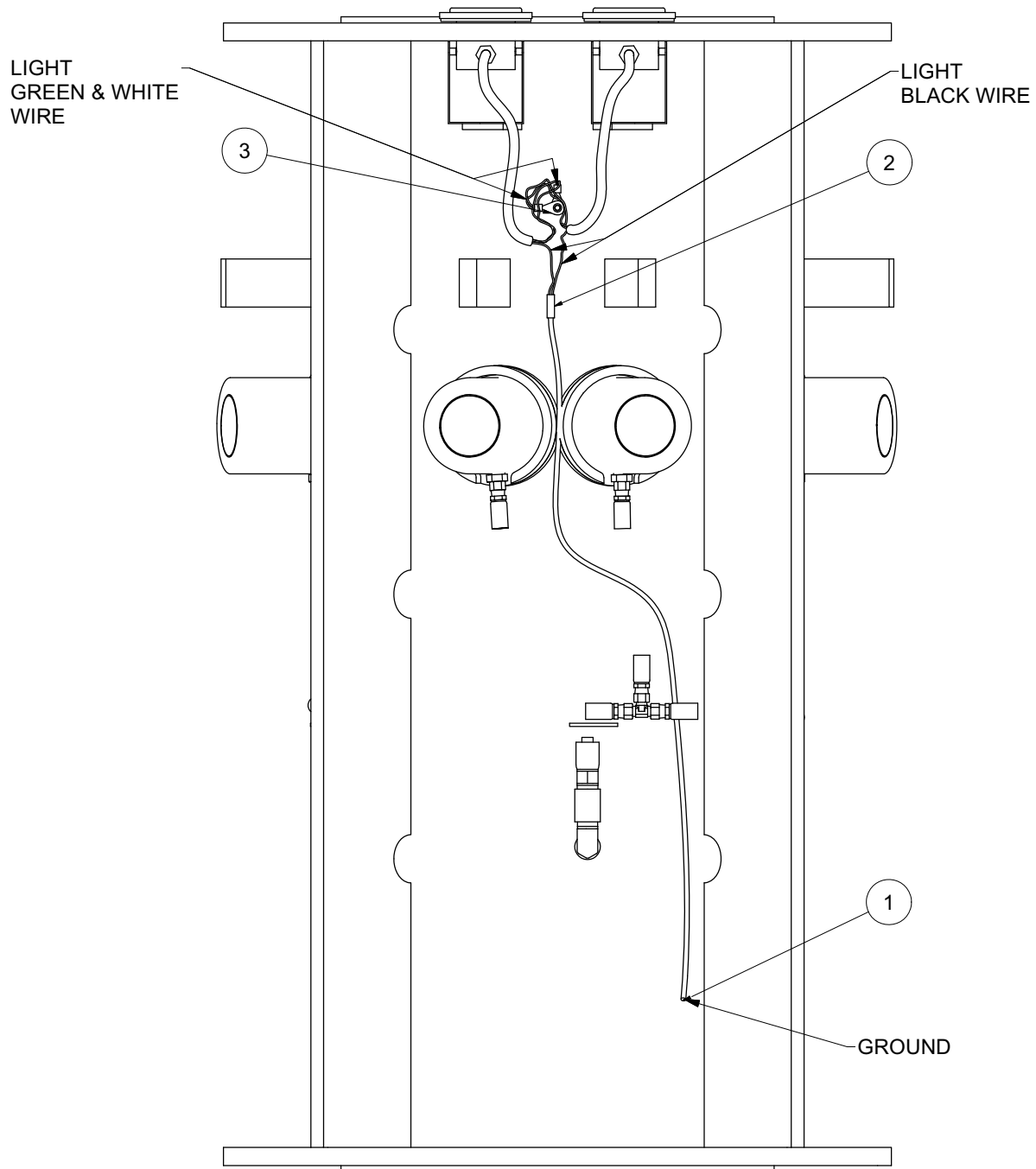

Steering Head (Electrical)

OTS

ITEM	QTY	PART NO.	DESCRIPTION
1	1	X100110	WIRE, #16 STRAND RED, 40"
2	1	8031228	TERMINAL PUSH ON, FEML 10GA
3	2	X600058	RING TERMINAL 12-10 .3125

Steering Head (Light Components)

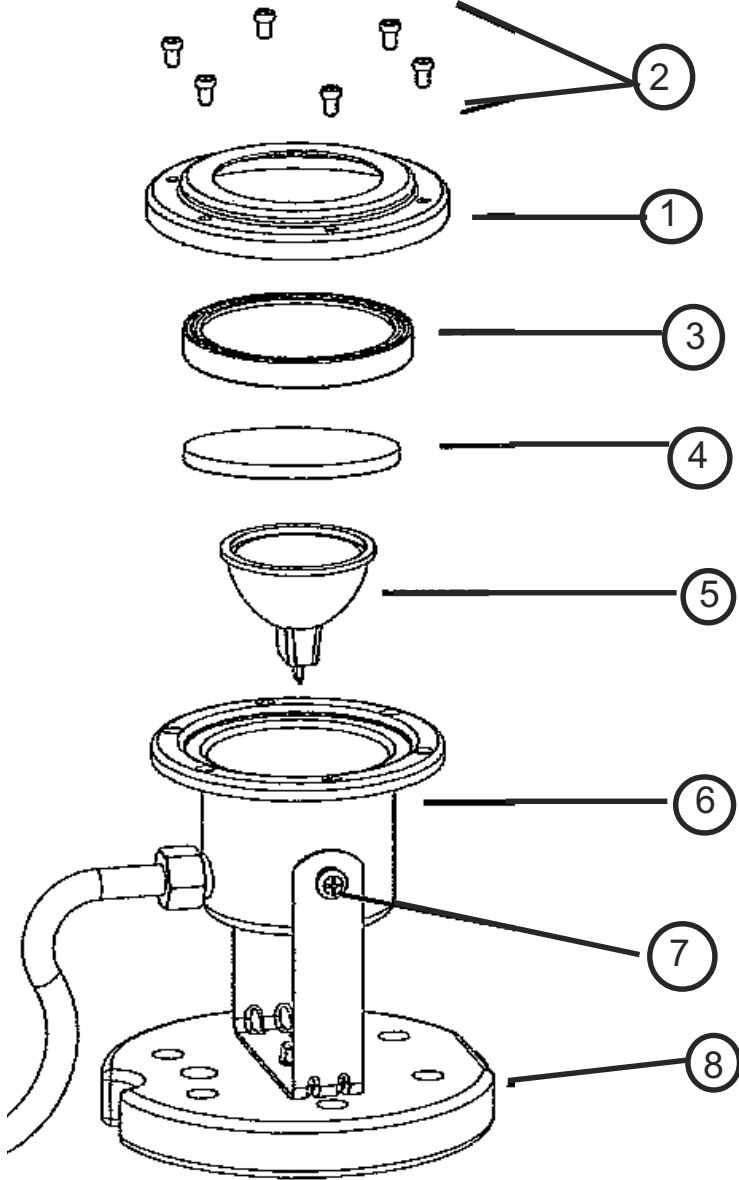

Steering Head (Light Components)

ITEM	QTY	PART NO.	DESCRIPTION
1	6	C501385-2	SCREWS
2	1	C501385-1	LENS CAP
3	1	C501385-3	GASKET
4	1	C501385-4	LENS
5	1	C501385-5	BULB, MR16 50W
6	1	C501385-6	BODY
7	2	C501385-7	ADJUSTMENT SCREW
8	1	C501385-8	BASE

PAGE LEFT BLANK

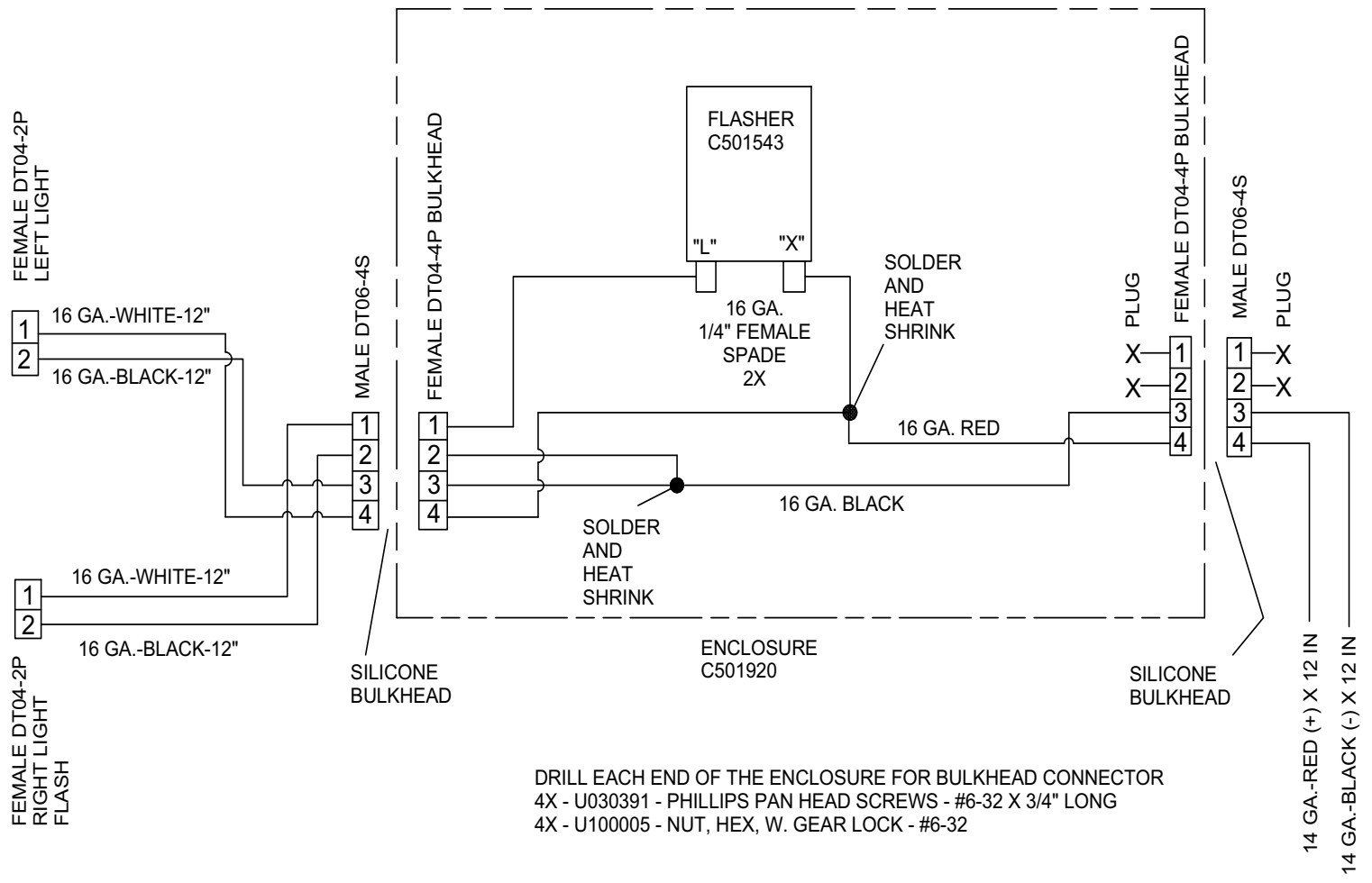

DRILL EACH END OF THE ENCLOSURE FOR BULKHEAD CONNECTOR
 4X - U030391 - PHILLIPS PAN HEAD SCREWS - #6-32 X 3/4" LONG
 4X - U100005 - NUT, HEX, W. GEAR LOCK - #6-32

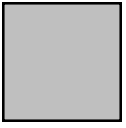

PAGE LEFT BLANK

WARRANTY/RETURN GOODS

McLAUGHLIN LIMITED WARRANTY

The Manufacturer warrants its products to be free from defects in material and workmanship for a period of twelve months from the date of shipment from the factory. The Manufacturer shall not be responsible for any damage resulting to or caused by its products by reason of installation, improper storage, unauthorized service, alteration of the products, neglect, or abuse, or use of the product in a manner inconsistent with its design. This warranty does not extend to any component parts not manufactured by Manufacturer; however, Manufacturer's warranty herein shall not limit any warranties made by manufacturers of component parts which may extend to Buyer.

Claims or defects in material and workmanship shall be made in writing to Manufacturer within ten days of discovery of defect. Manufacturer may either send a service representative or have the product returned to its factory at Buyer's expense for inspection. Upon notification of defect, Manufacturer will issue a return good authorization number to Buyer. The return goods authorization number must accompany the product returned. If judged by the Manufacturer to be defective in material or workmanship, the product will be replaced or repaired at the option of Manufacturer, free from all charges except authorized transportation. Buyer shall be responsible for all maintenance services consisting of lubrication and cleaning of equipment, replacing expendable parts, making minor adjustments and performing operating checks, all in accordance with procedures outlined in Manufacturer's maintenance literature.

THE FOREGOING WARRANTY IS IN LIEU OF ALL OTHER WARRANTIES, AND NO REPRESENTATIONS, GUARANTEES, OR WARRANTIES, EXPRESS OF IMPLIED, (INCLUDING BUT NOT LIMITED TO, A WARRANTY OF MERCHANTABILITY OR FITNESS FOR A PARTICULAR PURPOSE,) ARE MADE BY THE MANUFACTURER IN CONNECTION WITH THE MANUFACTURE OR SALE OF ITS PRODUCTS. NO EMPLOYEE, DISTRIBUTOR OR REPRESENTATIVE IS AUTHORIZED TO CHANGE THIS WARRANTY IN ANY WAY OR GRANT ANY OTHER WARRANTY ON BEHALF OF MANUFACTURER.

THE REMEDIES OF BUYER SET FORTH HEREIN ARE EXCLUSIVE AND ARE IN LIEU OF ALL OTHER

BEYOND ITS OBLIGATION TO REPAIR OR REPLACE, AT ITS OPTION, ANY PRODUCT OR PART FOUND BY MANUFACTURER TO BE DEFECTIVE IN MATERIAL OR WORKMANSHIP. MANUFACTURER SHALL NOT BE LIABLE FOR COST OF INSTALLATION AND/OR REMOVAL OR BE RESPONSIBLE FOR DIRECT, INDIRECT, SPECIAL OR CONSEQUENTIAL DAMAGES OF ANY NATURE.

FOR SERVICE OR ASSISTANCE, SEE THE AUTHORIZED McLAUGHLIN DEALER IN YOUR AREA.

GENERAL RETURNS FOR MERCHANDISE

1. All material returned to McLaughlin Mfg. Company must have a return authorization number. This number can be obtained by calling the dealer from whom the material was originally purchased.
2. All returned material must be shipped PREPAID.
3. Material without a material authorization number or returned collect will be refused at our dock.
4. All material ordered incorrectly or new material returned for no valid reason will be subject to a 20% restocking charge.
5. In the case of warranty claims, a letter explaining the problem or requesting repair must accompany the material.
6. On warranty consideration, all material shipped by McLaughlin will be invoiced until the defective material is returned for inspection. After inspection, credit will be issued for all parts deemed defective.
7. All return authorized numbers expire 30 days after issue. After this time, warranty claims and material returns are void, and merchandise must be paid in full.
8. McLaughlin must be notified and authorize all warranty work performed by your service personnel. This authorization must be obtained PRIOR to any work being performed for proper warranty consideration. Credit will not be issued for unauthorized service work performed.

